

TDI 200 SERIES PRE MARCH 1994

Fitment to: Left hand side
Fitting time: 60 minutes
Special Tools: Rivnut Installer
Super Glue

Instructions:

1. Remove the air cleaner intake grill from the left hand fender by carefully levering, using a screw driver. Tape around the paintwork to avoid damage.
 2. Position the snorkel on the vehicle. The raised section on the back of the snorkel body should locate in the air intake hole. Allow approximately 5mm between the trailing edge of the snorkel body and the rear edge of the guard. Mark the 3 lower mounting hole positions and remove the snorkel body.
 3. Remove the 5 self-tapping screws from the flange around the inside of the air intake hole. Push the inner duct off the body work 5mm.
 4. Drill the front 2 mounting holes to 9.5mm. The rear hole should be drilled to 4.5mm. Insert rivnuts into the forward hole positions using a rivnut installer. Place a small bead of supa-glue around the outer lip of the rivnuts. This will ensure they don't spin during installation.
-

ITEM	DESCRIPTION	QTY	PART NO
1	BODY - SNORKEL	1	810-133-000
2	3" AIR RAM ASSEMBLY	1	000-135-050
3	BRACKET - UPPER MOUNTING	1	810-032-000
4	GASKET - UPPER BRACKET	1	810-435-000
5	SCREW - S/T - 4.2 x 13mm	5	000-951
6	BOLT - HEX - 6mm x 1.0 x 12mm	3	000-002-100
7	BOLT - HEX - 6mm x 1.0 x 30mm - BL/ZN	2	000-005-100
8	BOLT - S/T - 6mm x 26mm BL/ZN	1	000-944-100
12	WASHER - BODY - 6mm x 16mm - BL/ZN	3	000-310-100
11	RIVNUT - 6mm	2	000-954
13	GASKET - FOAM	1	810-016-000
14	CLAMP - HOSE - 50/70	2	000-906
15	HOSE CLAMP - SIZE 48 (BLACK)	1	000-918/B

5. Apply a bead of silicone between the inner duct and the vehicle body. Re-fasten the duct to the body work using the 5 self tapping screws. Smear any excess silicone to ensure a waterproof seal.
 6. Bolt the upper mounting bracket to the snorkel body. Sit the snorkel in place on the vehicle. Mark the 5 upper mounting holes using a felt pen. Remove the snorkel. Drill the upper holes to 3.5mm. The lowest of these holes may be solid, so allow enough depth for the 13mm screw. If this is the case, this hole may have to be drilled to 4mm.
 7. Use a bead of silicone to adhere the foam gasket to the back of the snorkel body. The bracket gasket can be joined to the mounting bracket using the same method.
 8. Position the snorkel on the vehicle and secure using appropriate hardware. A large bead of silicone should be used to seal the snorkel against the vehicle body.
 9. On some vehicles, there are no clamps supplied on the air entry/air cleaner duct. If this is the case, use the 50/70 clamps in the kit to secure this hose. This is essential to the watertight operation of the Safari Snorkel.
 10. Sit the air ram on top of the snorkel and tighten the clamp.
-

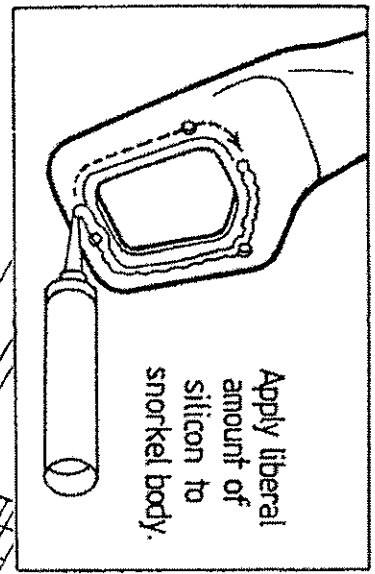
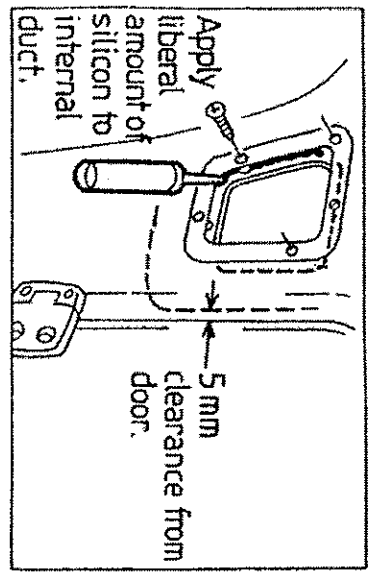

Apply liberal amounts of silicone to all connections

Seal snorkel body to vehicle with silicone.

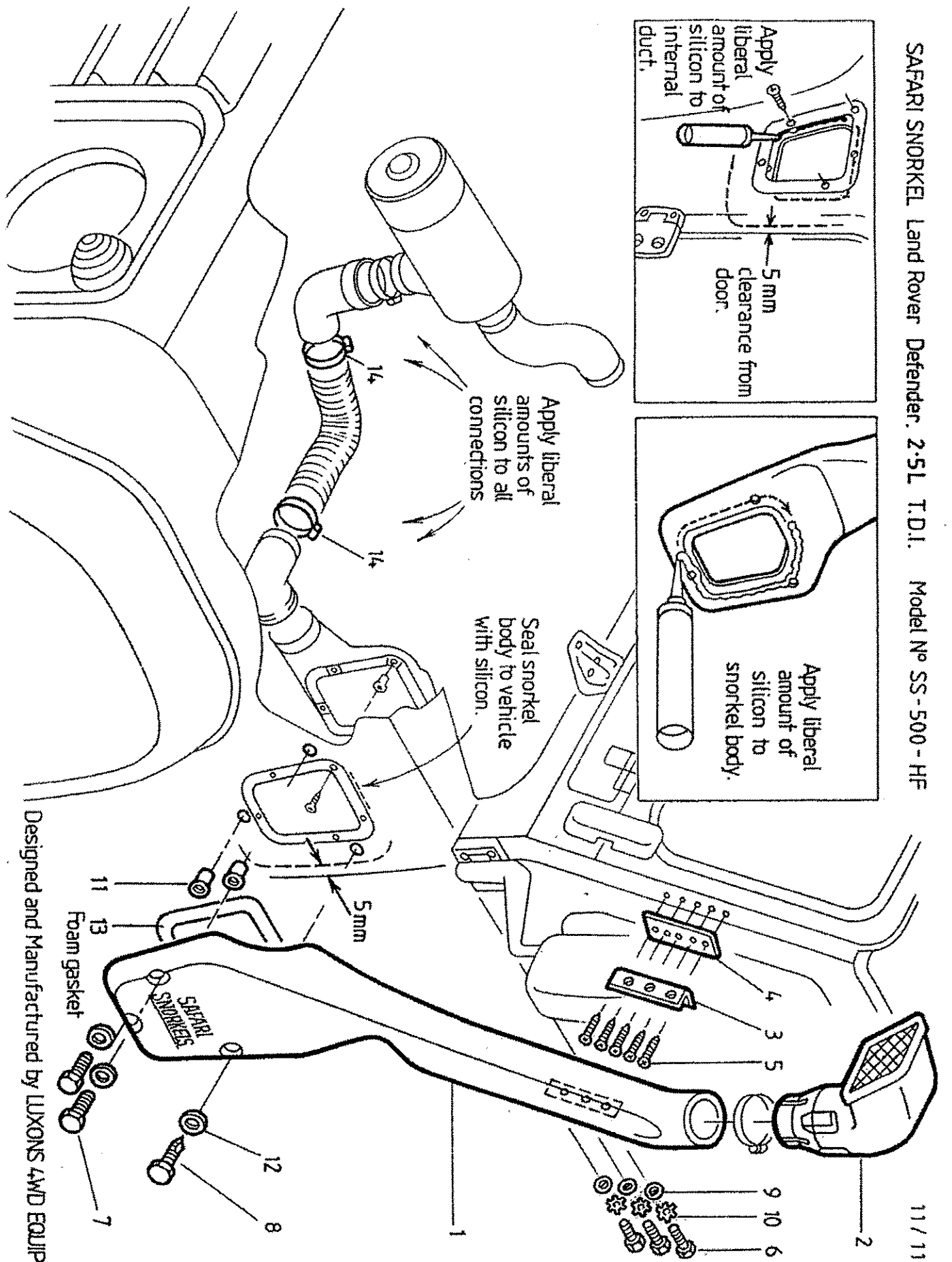

Designed and Manufactured by LUXONS 4WD EQUIPMENT